

THE SOLENOID VALVE MAINTENANCE



1

Close water supply with the tool take out the power box cover.



2

With tool take out the screws of the solenoid valve, and take out the valve.

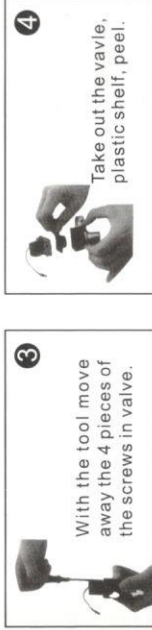

3

With the tool move away the 4 pieces of the screws in valve.



4

Take out the valve, plastic shell, peel.



5

Clean the peel clean the peel with water, make sure no dirty in the hole. And then fix the peel.

ADJUST THE SENSOR DISTANCE

Notes: the products can self adjust the sensor distance and had a strict testing during produce, no special needed, do not adjust. If really need adjust, please do as follows.

With the tool, gently adjust, will longer the sensor distance with clockwise circumrotate, and shorter the distance with anticlockwise.



NOTICE

TO CLEAN INDUCTIVE WINDOW



In order to keep it clean, please clean lightly the inductive window with soft dry clothes after installation.

Note: The cleanness of inductive window will influence the induction distance

TO ENSURE TO OPEN THE SWITCH BELOW

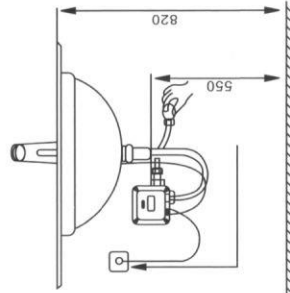

The machine will enter into the test condition after installing and ten seconds later, the switch can be opened and work normally.

Note: 1. When the machine is in the condition of self-examination, it belongs to the normal phenomenon that the sound of the electromagnetic valve will appear probably.

2. If the inductive distance is very short, please move the barrier away and machine will recover a normal 5 or 6 minutes later.

3. If the induction distance shifts from farness to nearness and the water is always flowing, the best distance will automatically be set 5 minutes later.

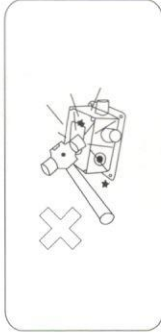
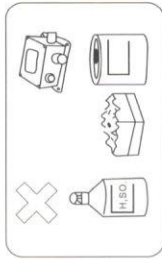

When for cleaning the products, please do not use the acid or alkaline cleaner, and should not shower water to products, no knock.

ELIMINATION OF SIMPLE TROUBLE

Phenomenon	Possible reason	The way to solve
No water flows	No power The sensor distance is in self-adjustment from long to short after the faucet installation.	Replace of new battery Wait for 5 mins Clean it Wait for water supplied
Could not close water	Dirty in the induction window No water supplied Dirty of the filter Not in suitable water pressure The last time working is as long as 90 seconds	Clean filter Provide suitable water pressure Leave away for 2 seconds, then let it work. Fix new battery Provide the suitable water pressure
After close water still drop water	Dirty in the solenoid valve (take out filter) Dirty in induction window Barrier in induction window Water pressure is too low Dirty in solenoid valve (take out filter)	Make the water into the solenoid valve to clean the solenoid valve Clean it Move away the barrier Provide suitable water pressure Make the water into the solenoid valve to clean the solenoid valve
Too little water flows	Too small of inlet water pipe Dirty in filter Too low water pressure	Provide standard supplied water pipe Clean filter Clean filter
The battery is in short life	Use non-alkaline bad battery Too long of the sensor distance (it effects by the environment)	Use AA alkaline battery adjust the light sensor, but it flows water adjust the distance



AUTOMATIC FAUCET SPECIFICATION MANUAL

FUNCTION AND CHARACTER

- Automatic function:** When your hands approach the inductive parts, the water will come out and when your hands leave, it will stop automatically.
- Cleanness and Sanitation:** The water will come out and stop automatically without touching the metal parts and it is convenient and hygienic. In case of germ' crossed infection, it must be disinfected effectively and flushed once automatically after an interval of 24 hours if necessary.
- Function of saving water:** Because of your busyness, automatic function can prevent you from wasting water, and there is overtime induction or the automatic function of the induction because of its continuous misleading by eyewitnessers, and the effect of saving water is obvious.
- Faucet filter:** The setup of filter can prevent the sand and solid materials in the water from outflow.
- Installation of simple dry battery:** Troublesome work of electric wiring can be omitted and you will feel much safer.
- The inductive distance can be adjusted automatically (optional)** according to the lavatory and environment.
- Elegant appearance:** Streamline design on product exterior caters to modern trends.
- Self-adjust the inductive range** according to the size of washbasin and application condition. Regular adjusting inductive range malfunction caused by changes of application condition can be avoided.
- Flushing electromagnetic valve and water-softened device** are installed inside. It is easy to use with the feature of even and smooth draining